

SmartMate

SMARTMATE ICF2S70M4LD35M

Offering maximum versatility, the Philips Advance family of SmartMate ballasts for 4-pin compact fluorescent lamps drive a broad range of quad and triple-tube, circline, 2D, and long twin-tube lamps. SmartMate ballasts' energy efficient design, compact and lightweight housing, and user-friendly features make these ballasts an ideal choice for fixture manufacturers, retrofitters, and MRO replacement.

Offering maximum versatility, the Philips Advance family of SmartMate ballasts for 4-pin compact fluorescent lamps drive a broad range of quad and triple-tube, circline, 2D, and long twin-tube lamps. SmartMate ballasts' energy efficient design, compact and lightweight housing, and user-friendly features make these ballasts an ideal choice for fixture manufacturers, retrofitters, and MRO replacement.

Product data

General Information

Lamp Type	CFTR70W/GX24Q
Number Of Lamps	2 piece/unit
Ballast Type	Electronic Fluorescent
Base Model	ICF2S70M4LD
Suitable For Outdoor Use	Yes
Automatic Restart	Yes

Operating and Electrical

Input Voltage	120 to 277 V
Input Frequency	50 to 60 Hz
Total Harmonic Distortion USA	10 %
Ignition Method	Programmed Start
Crestfactor (Nom)	1.5
Ignition Time (Nom)	1.5 s
Ballast Factor (Nom)	1
Power Factor (Nom)	0.98
Input Current (Max)	1.30 A
Input Current (Min)	0.56 A
Input Power (Nom)	156-152 W
Rated Lamp Power	70W W

Wiring

Color Input Terminals	Black and White
Color Output Terminals	RED, YEL & BLU

Wire Striplength	0.375 mm
Lamp Connection	Series
Wire Length By Color	No wires
Wire Gauge (Nom)	18AWG mm
Wire Type	Solid
Remote Wiring Configuration Allowed	Yes
Tandem Wiring Configuration Allowed	Yes
Through Wiring Configuration Allowed	Yes
Max Ballast-Lamp Distance Remote Wiring	6'
Max Ballast-Lamp Distance Tandem Wiring	Red = 6'
Max Ballast-Lamp Distance Through Wiring	Red = 6'
Connector Type	Poke-In

Temperature

T-Case Maximum (Nom)	75 °C
----------------------	-------

PHILIPS

• Mechanical and Housing

Housing Material	Metal
Housing	M4
Housing Dimensions	7.79" x 3.0" x 1.29"

• Approval and Application

EMC Immunity Standard	FCC Non-Consumer
Approval Marks	CSA certificate UL certificate CEC Listing RoHS Compliant
Hum And Noise Level	A

UL Recognized No

• Product Data

Order product name	SMARTMATE ICF2S70M4LD35M
EAN/UPC - Product	781087030851
Order code	913710209302
Numerator - Quantity Per Pack	1
Numerator - Packs per outer box	20
Material Nr. (12NC)	913710209302
Net Weight (Piece)	559.000 g

Dimensional drawing

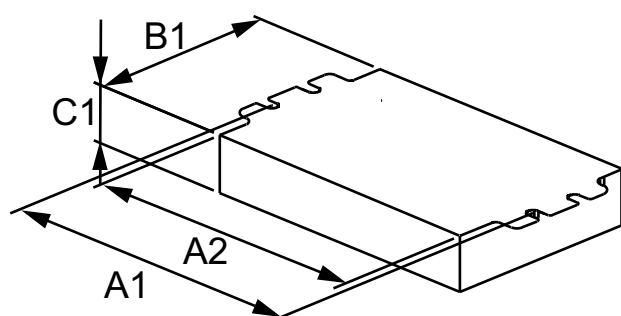

Studs for -BS models only
-LD models do not have mounting studs

ELE BALLAST (2) 70W CFL (4-PIN) 120-277V

Product	A1	A2	B1	C1
SMARTMATE ICF2S70M4LD35M	7.79 in	7.00 in	3.00 in	1.29 in

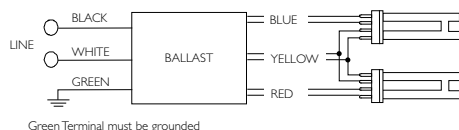

© 2016 Philips Lighting Holding B.V.
All rights reserved.

Specifications are subject to change without notice. Trademarks are the property of Koninklijke Philips N.V. (Royal Philips) or their respective owners.

www.philips.com/lighting

2016, February 1
data subject to change