

# Plusrite®

CATALOG NUMBER: BALU100-R/V120

## 100W S54

High Pressure Sodium Lamp Ballast  
60 Hz Reactor-HPF

### 0.75EI CORE.WMF

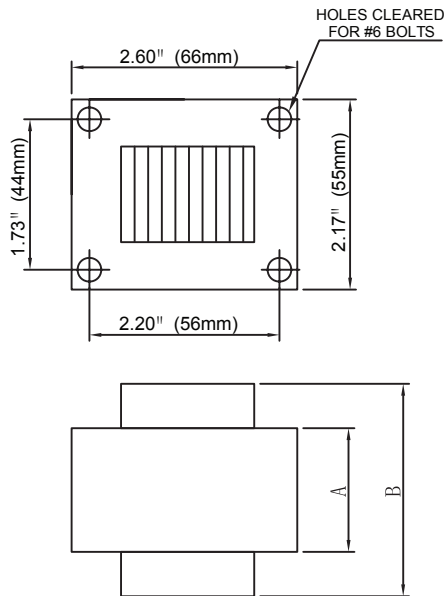

#### Capacitor:

Microfarads: 38.0 uf  
Volts (Min): 150 V  
Case Temp(Max): 100°C  
D: 1.77 in  
L: 3.66 in  
A: 0.63 in

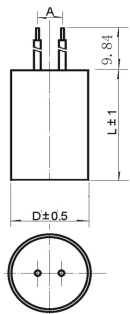

Dry Type Capacitor with Leads

#### Ignitor:

Case Temp (Max): 105 °C  
BTL Distance (Max): 2 ft

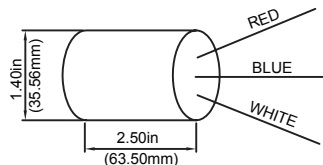

Input Volts	120			
Circuit Type	R-HPF			
REGULATION				
Line Volts	±5%			
Lamp Watts	±10%			
LINE CURRENT( Amps )				
Operating	1.10			
Open Circuit	1.80			
Starting	0.90			
RECOMMENDED FUSE (Amps)	4			
TEMPERATURE RATINGS				
Insulation Class	180 (H)			
Coil Temperature Code	F			
Benchtop Coil Rise				
Power Factor (Min)	90%			
Input Watts	116 W			
Efficiency				
NOM. OPEN CIRCUIT VOLTAGE	120			
INPUT VOLTAGE AT LAMP DROPOUT	79.5			
MIN AMBIENT STARTING TEMP	-40°F/-40°C			
60 HZ TEST PROCEDURES				
High Potential Test (Volts)				
1 Minute	2,000 V			
1 Second	2,500 V			
Open Circuit Voltage Test (V)	110-135			
Short Circuit Current Test (A)				
Secondary Current	Min	2.60		
	Max	2.86		
Input Current	Min			
	Max			
CORE and COIL Specifications				
Dimension A (in)	1.97			
Dimension B (in)	3.15			
Weight (lbs)	2.70			
Lead Lengths (in)	12			
CAPACITOR REQUIREMENT				
Microfarads	38.0 uf			
Volts (Min)	150 V			

### Wiring Diagram:

c **AL** <sup>®</sup> **US** RoHS

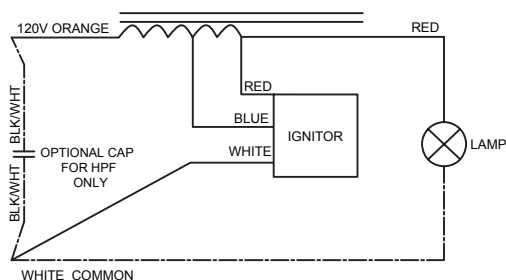

### ORDERING INFORMATION

The ballast comes with a kit including capacitor, ignitor and bracket.

Data is based upon tests performed by Plusrite in a controlled environment and is representative of relative performance. Actual performance can vary depending on operating conditions. Specifications are subject to change without notice.

Coil material: AL